

CATALOGUE CATALOGUS KATALOG

2013

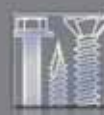

www.powerseurope.com

Forced entry
Geschoten montage
Direktmontage
Clouage
Skjutmontage



Powers®

† Suitable - Geschikt - Geeignet - Adapté - Lämpig

‡ May be suitable depending on application - Kan geschikt zijn afhankelijk van toepassing - Kann geeignet sein, abhängig von Anwendung - Peut convenir suivant l'application - Kan vara användbar i vissa applikationer



Drywall Arbouw Trocebau Plaque Gipsplätt	Electricians / Plumbers Electrotechniek / loodgieter Elektriker / SHK Electricians / Plombiers Elektriker / Rohmökare	Roofing Dakdekkerij Dach Toitures Tak	General Construction Algemene Bouwwerkzaamheden Allgemein Bau Construction générale Generala konstruktioner										
--	---	---	---	--	--	--	--	--	--	--	--	--	--

Type		specs												
Nails / Nagels / Nägel / Clous / Spik														
C4 Nails	C4	33	20-65mm											
C4 Nails HD	C4-HD	33	20-65mm											
C4 Nails XH	C4-XH	33	17-38mm	†	†									
C5 Nails	C5	37	15-40mm	†	†									
C5 Nails HD	C5-HD	37	20-40mm											
C5 Nails XH	C5-XH	37	17-38mm	†	†									
C3 Nails	C3	38	13-38mm	†	†								†	†
C3 Nails XH	C3 XH	38	17-38mm	†	†									†
700 Nails	T1700	39	13-38mm	†	†									†
700 Nails XH	T1700-XH	39	17-38mm	†	†									†
P-nails	P	44	16-76mm	†	†									†
Ballistic P-nails	P-HC	44	13mm, 19mm	†	†									†
Top hat pins	P-TH	44	16mm, 25mm											†
Washed head pins	P-W	44	25mm, 37mm											†
Insulation washer drive pins	P-IW	45	38-51-64mm											†
Ceiling clip pins	P-CC	45	25mm, 32mm											†
Conduit clip pins	PCOND	45	13-32mm											†
HD steel pins	PHD	45	16mm	†	†									†
DN nails	DN	48	16-72mm	†	†									†
P3X nails	P3X	42	15-60mm	†	†									†
NK nails	NK	47	16-97mm	†	†									†
D-head nails 34° with gas	DH	53	51-90mm										†	
Full Round Head nails 21° with gas	FRH	55	63-90mm										†	
Haften nails 21° with gas	FRH-HAFT	55	25mm										†	
Anchor nails 21° with gas	FRH-AN	57	40-60mm										†	
Straight brad nails 16 Gauge, NO GAS	BRADF16-NO	60	19-64mm										†	
Angled brad nails 16 Gauge 20°, NO GAS	ANGLEBRAD-NO	59	32-64mm										†	
D-head nails 34° NO GAS	DH-NO	58	51-90mm										†	
Angled brad nails 16 Gauge 20° with gas	ANGLEBRAD	60	32-64mm										†	
Straight brad nails 16 Gauge with gas	BRADF16	59	19-64mm										†	
Cartridges / Patronen / Kartuschen / Charges / Patroner														
C4 Gas	GREEN CAN	33		†	†									
C5 Gas	C5 CAN	37		†	†									
C3 Gas	BLUE CAN	38		†	†									
700 Gas	700 GAS	39		†	†									
Powderloads strip	PSL	43		†	†									
Powderloads disk	PDL	42		†	†									
W3 Gas	RED CAN	53												
Mini gas	GAS MINI	59												
Accessories / Accessoires / Zubehör / Accessoires / Tillbehör														
Washer 25mm	ST-LW-25MM	40		†	†									†
Washer 36mm	ST-LW-36MM	40			†									†
Washer 13mm	ST-LW-13MM	40		†	†									†
Cable binder 25mm	ST-CBL-TIE-25MM	40			†									†
Rod hanger	ST-ROD-6MM	40			†									†
Eye clip	ST-EYE-CLIP	40			†									†
Washer 25mm	TILW-PULSA-LW	40			†									†
Cable bow double	CABLE-BOW-DBL	40			†									†
Plastic washer 36mm	ST-PLW-36MM	40			†									†
Perfoband 12mm	PERFOBAND-12MM	40	10 mtr		†									†
Cable bow single for Trak-It-E	EN-CBL-BOW-SNGL	40			†									†
Cable bow double for Trak-It-E	EN-CBL-BOW-DBL	40			†									†
Cable holder for Trak-It-E	EN-CBL-HLDR-20	40			†									†
Quickclips	QKCL	41	14-40mm		†									†
Conduit clips	ST-COND	41	13-28mm		†									†
Plastic clips	CLIP-PL	41	16-32mm		†									†
Metal conduit clips	TICOND	49	12-32mm		†									†



1

2

3

4

5

6

7

8

9

10

11

12

13

14

15

16

17

18

19

20

21

22

23

24

25

26

27

28

29

30

31

32

33

34

35

36

37

38

39

40

41

42

43

44

45

46

47

48

49

50

51

52

53

54

55

56

57

58

59

60

61

62

63

64

65

66

67

68

69

70

71

72

73

74

75

76

77

78

79

80

81

82

83

84

85

86

87

88

89

90

91

92

93

94

95

96

97

98

99

100



	Trak-It® C4 gastool	32
	Trak-It® C4 gasschiethamer	
	Trak-It® C4 Gasnagelgerät	
	Trak-It® C4 cloueur à gaz	
	Trak-It® C4 spikpistol	

	Trak-It® C4 nails and gas	33
	Trak-It® C4 nagels en gas	
	Trak-It® C4 Nägel und Gas	
	Trak-It® C4 clous et cartouches de gaz	
	Trak-It® C4 spik och bränslecell	

	Trak-It® C5 / C5-ST gastool	36
	Trak-It® C5 / C5-ST gasschiethamer	
	Trak-It® C5 / C5-ST Gasnagelgerät	
	Trak-It® C5 / C5-ST cloueur à gaz	
	Trak-It® C5 / C5-ST spikpistol	

	Trak-It® C5 nails and gas	37
	Trak-It® C5 nagels en gas	
	Trak-It® C5 Nägel und Gas	
	Trak-It® C5 clous et cartouches de gaz	
	Trak-It® C5 spik och bränslecell	

	Trak-It® C3 nails and gas	38
	Trak-It® C3 nagels en gas	
	Trak-It® C3 Nägel und Gas	
	Trak-It® C3 clous et cartouches de gaz	
	Trak-It® C3 spik och bränslecell	

	Trak-It® nails and gas for Spit® Pulsa 700	39
	Trak-It® nagels en gas voor Spit® Pulsa 700	
	Trak-It® Nägel und Gas für Spit® Pulsa 700	
	Trak-It® clous et cartouches de gaz pour Spit® Pulsa 700	
	Trak-It® spik och bränslecell för Spit® Pulsa 700	

	Trak-It® accessories	40
	Trak-It® accessoires	
	Trak-It® Zubehör	
	Trak-It® accessoires	
	Trak-It® tillbehör	

	Trak-It® Quick-Clip plastic clips – halogen free	41
	Trak-It® Quick-Clip klembeugels – halogeenvrij	
	Trak-It® Quick-Clip Klemmschellen – halogenfrei	
	Trak-It® Quick-Clip attaches plastiques – sans halogène	
	Trak-It® Quick-Clip plastclips – halogen fri	

	Trak-It® conduit clips	41
	Trak-It® haakbeugels	
	Trak-It® Rohrschellen	
	Trak-It® crochets simples	
	Trak-It® rörclips	

	Trak-It® conduit clips plastic – halogenfree	41
	Trak-It® haakbeugels plastic – halogeenvrij	
	Trak-It® Rohrschellen Plastik – halogenfrei	
	Trak-It® crochets plastiques – sans halogène	
	Trak-It® rörclips plast – halogen fri	

	P3X powder actuated tool with magasin	42
	P3X kruitschiethamer met magazijn	
	P3X vollautomatisches Bolzensetzgerät	
	P3X cloueur à poudre avec chargeur	
	P3X bultpistol med magasin	

	Powder loads in disk	42
	Kruitpatronen in disk	
	Rundkartuschen	
	Charges propulsives sur disque	
	Patroner på skiva	

	Nails in strip for Powers P3X	42
	Nagels in strip passend voor Powers P3X	
	Nägel magaziniert für Powers P3X	
	Clous en bande pour Powers P3X	
	Magasinerad skjutspik för Powers P3X	

	P3500 powder actuated tool	43
	P3500 kruitschiethamer	
	P3500 Bolzensetzgerät	
	P3500 cloueur à poudre	
	P3500 bultpistol	

	Powder loads in strip	43
	Kruitpatronen in strip	
	Streifenkartuschen	
	Charges propulsives en bandes	
	Patroner i plastband	

	Pins	44
	P-nagels	
	Kopfbolzen	
	Clous	
	Skjutspik	

	P450 powder actuated tool	46
	P450 kruitschiethamer	
	P450 Bolzensetzgerät	
	P450 cloueur à poudre	
	P450 bultpistol	

	Powder loads in strip	47
	Kruitpatronen in strip	
	Streifenkartuschen	
	Charges propulsives en bandes	
	Patroner i plastband	

	NK pins fitting for P450/DX450	47
	NK nagels passend voor P450/DX450	
	Kopfbolzen für P450/DX450	
	NK clous a tête pour P450/DX450	
	NK skjutspik passande P450/DX450	

	DN nails in strip for Powers PA351	48
	DN nagels in strip voor Powers PA351	
	Kopfbolzen magaziniert für Powers PA351	
	DN clous en bande pour Powers PA351	
	DN magasinerad skjutspik för Powers PA351	

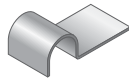

Conduit clips metal
 Haakbeugels metaal
 Rohrschellen Metall
 Crochet métal
 Rörclips metall

49



Nail-It W3-34CDH gastool for wood
 Nail-It W3-34CDH gasschiethamer voor hout
 Nail-It W3-34CDH Gasnagelgerät für Holz
 Nail-It W3-34CDH cloueur à gaz pour bois
 Nail-It W3-34CDH spikpistol för trä

52



Nail-It W3-34CDH nails and gas
 Nail-It W3-34CDH nagels en gas
 Nail-It W3-34CDH Nägel und Gas
 Nail-It W3-34CDH clous et cartouches de gaz
 Nail-It W3-34CDH spik och bränslecell

53



Nail-It W3-21FRH gastool for wood
 Nail-It W3-21FRH gasschiethamer voor hout
 Nail-It W3-21FRH Gasnagelgerät für Holz
 Nail-It W3-21FRH cloueur à gaz pour bois
 Nail-It W3-21FRH spikpistol för trä

54



W3-21FRH/HAFT gastool for wood
 W3-21FRH/HAFT gasschiethamer voor hout
 W3-21FRH/HAFT Gasnagelgerät für Holz
 W3-21FRH/HAFT cloueur à gaz pour bois
 W3-21FRH/HAFT spikpistol för trä

54



W3-21FRH/HAFT nails and gas
 W3-21FRH/HAFT nagels en gas
 W3-21FRH/HAFT Nägel und Gas
 W3-21FRH/HAFT clous et cartouches de gaz
 W3-21FRH/HAFT spik och bränslecell

55



Nail-It W3-21FRH nails and gas
 Nail-It W3-21FRH nagels en gas
 Nail-It W3-21FRH Nägel und Gas
 Nail-It W3-21FRH clous et cartouches de gaz
 Nail-It W3-21FRH spik och bränslecell

55



W3-21FRH/AN gastool for wood
 W3-FRH/AN gasschiethamer voor hout
 W3-21FRH/AN Gasnagelgerät für Holz
 W3-21FRH/AN cloueur à gaz pour bois
 W3-21FRH/AN spikpistol för trä

56



Nail-It W3-21FRH/AN nails and gas
 Nail-It W3-21FRH/AN nagels en gas
 Nail-It W3-21FRH/AN Nägel und Gas
 Nail-It W3-21FRH/AN clous et cartouches de gaz
 Nail-It W3-21FRH/AN spik och bränslecell

57



34° paper collated D-head nails
 34° papiergebonden D-kopnagels
 34° D-Kopfnägel auf Papierstreifen
 D-tête pointes d'angle 34° en bande papier
 34° papperbandad D-huvud spik

58

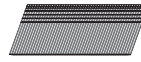

20° Angle brads and gas
 20° Schuine nagels en gas
 20° Schräge Stauchkopfnägel und Gas
 Clous de finition 20° et cartouches à gaz
 Dyckert snedställd 20° och bränslecell

59

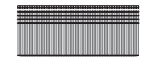

Straight brads and gas
 Rechte brads en gas
 Stauchkopfnägel und Gas
 Clous de finition et cartouches de gaz
 Dyckert rak och bränslecell

59



Straight brads
 Rechte brads
 Stauchkopfnägel
 Clous de finition
 Dyckert rak

60

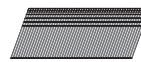

20° Angle brads
 20° Schuine brads
 20° Schräge Stauchkopfnägel
 Pointes angle 20°
 Dyckert snellställd 20°

60





TRAK-IT® C4

General construction

Algemene bouwwerkzaamheden

Allgemein Bau

Construction générale

Allmänna konstruktioner

Page/ Pagina/ Seite / Page/ Sida



32

Impact strength in Joule
 Slagkracht in Joule
 Einschlagstärke in Joule
 Energie impact en Joule
 Energi / slagkraft i Joule

150 J

Weight in kg
 Gewicht in kg
 Gewicht in kg
 Poids en kg
 Vikt i kg

4,4kg

Type of nails
 Type nagels
 Nageltyp
 Type de clou
 Spiktyper/ längder

17-65mm Ø2,6 Ø3,7 Ø3,0

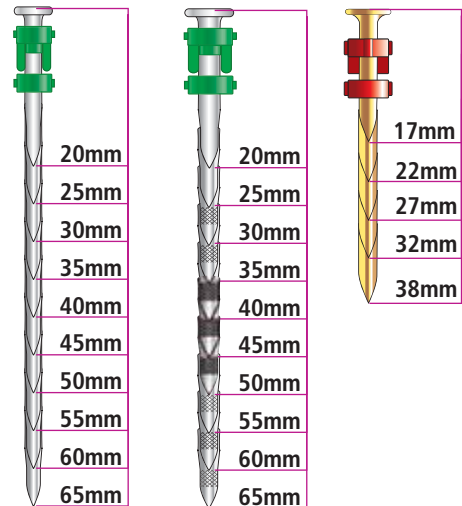

Compatible with Trak-It accessories - Stick-E
 Compatibel met Trak-It accessoires - Stick-E
 Kompatibel mit Trak-It Zubehör - Stick-E
 Compatible avec Trak-It accessoires - Stick-E
 Kompatibel med Trak-It tillbehör - Stick-E





TRAK-IT® C5

General Contractor & Drywaller

Aannemer & Afbouwer

Trockenbau & Innenausbau

Plaquiste & Entrepreneur général

Allmänna konstruktioner & Gipsreglar

36

112 J

3,65kg

TRAK-IT® C5-ST

Electrician & Plumber

Electricien & Loodgieter

Elektriker & Klempner

Electricien & Plombier

Elektriker & Rörmokare

36

112 J

3,55kg

15-40mm

Ø2,6

Ø3,7

Ø3,0

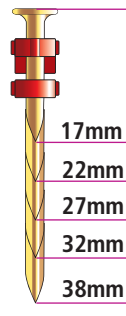
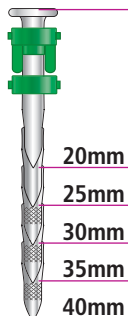
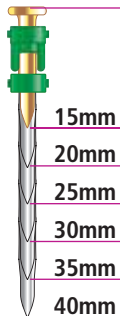

FORCED ENTRY





Trak-It® C4

150 Joules for 17mm-65mm nails in concrete
 150 Joules voor 17mm-65mm nagels in beton
 150 Joules für 17mm-65mm Nägel in Beton
 150 Joules pour des clous de 17mm-65mm dans le béton
 Kraftpaket 150 Joules für 17mm-65mm lång spik i betong



FORCED ENTRY

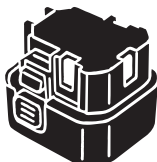

55583

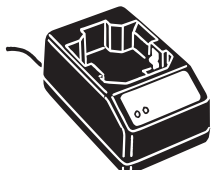

55638

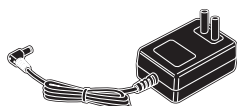

55620



55639



Brochure - powerseurope.com

252



150 Joules	4,4kg	L _{WA} = 113dB L _{PA} = 105dB	17-65mm	Ø2,6mm Ø3,0mm Ø3,7mm	40	Max. 800 fixings	x2 (6V, 1.5Ah) 5700 fixings per battery	Max. 150 min	L 450mm W 122mm H 467mm			

DEKRA

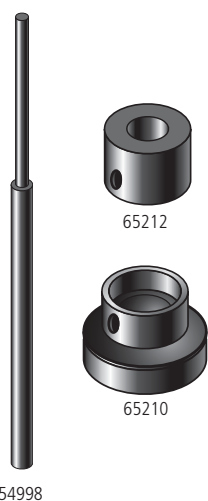

54998

65212

65210

Trak-It® C4 gastool			
Trak-It® C4 gasschiethamer			
Trak-It® C4 Gasnagelgerät			
Trak-It® C4 cloueur à gaz			
Trak-It® C4 spikpistol			
Type	Art. Nr.		
TI-C4 NAILER	55112	1	
12V CAR CHARGER	55639	1	
BATTERY	55583	1	
CHARGER BASE	55638	1	
ADAPTER CORD	55620	1	
PIN JAM CLEAR TOOL	54998	1	
C4 CONTACT TOP	65212	1	
C4-NSPC-PLW-36mm	65210	1	

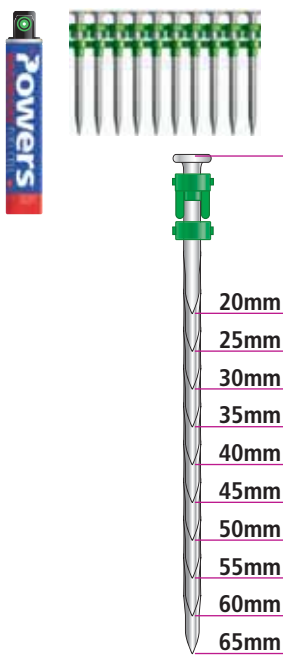

Trak-It® C4 nails and gas						
Trak-It® C4 nagels en gas						
Trak-It® C4 Nägel und Gas						
Trak-It® C4 clous et cartouches de gaz						
Trak-It® C4 spik och bränslecell						
Type	Art. Nr.					
GREEN TRAK-IT CAN	55218	1	100			
C4-20MM	65005	700+1	3500+5	20	6,3	2,6
C4-25MM	65010	700+1	3500+5	25	6,3	2,6
C4-30MM	65015	700+1	3500+5	30	6,3	2,6
C4-35MM	65020	700+1	3500+5	35	6,3	2,6
C4-40MM	65025	700+1	3500+5	40	6,3	2,6
C4-45MM	65030	700+1	3500+5	45	6,3	2,6
C4-50MM	65035	700+1	3500+5	50	6,3	2,6
C4-55MM	65040	700+1	3500+5	55	6,3	2,6
C4-60MM	65045	700+1	3500+5	60	6,3	2,6
C4-65MM	65050	700+1	3500+5	65	6,3	2,6

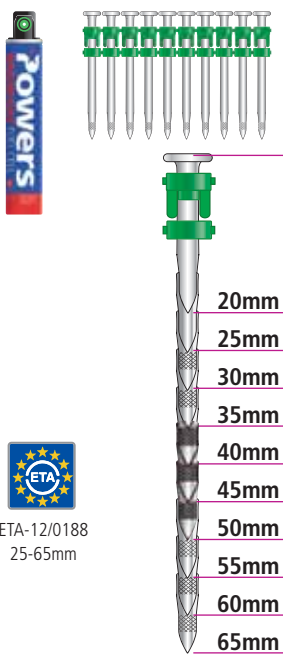

Trak-It® C4 HD nails and gas – for high shear loads						
Trak-It® C4 HD nagels en gas – voor hoge afschuifwaarde						
Trak-It® C4 HD Nägel und Gas – für hohe Querlasten						
Trak-It® C4 HD clous et cartouches de gaz – haute performance						
Trak-It® C4 HD spik och bränslecell – för höga sjuvkrafter						
Type	Art. Nr.					
C4-20MM-HD	65105	700+1	3500+5	20	6,3	3,7
C4-25MM-HD	65110	700+1	3500+5	25	6,3	3,7
C4-30MM-HD	65115	700+1	3500+5	30	6,3	3,7
C4-35MM-HD	65120	700+1	3500+5	35	6,3	3,7
C4-40MM-HD	65125	700+1	3500+5	40	6,3	3,7
C4-45MM-HD	65130	700+1	3500+5	45	6,3	3,7
C4-50MM-HD	65135	700+1	3500+5	50	6,3	3,7
C4-55MM-HD	65140	700+1	3500+5	55	6,3	3,7
C4-60MM-HD	65145	700+1	3500+5	60	6,3	3,7
C4-65MM-HD	65150	700+1	3500+5	65	6,3	3,7

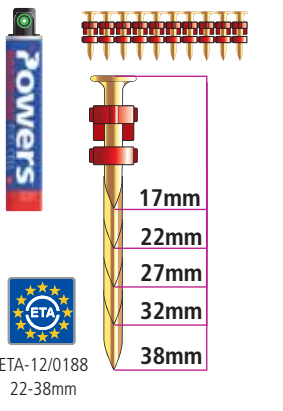

Trak-It® C4 XH nails and gas – for very hard concrete						
Trak-It® C4 XH nagels en gas – voor zeer hard beton						
Trak-It® C4 XH-Nägel und Gas – für sehr harten Beton						
Trak-It® C4 XH clous et cartouches de gaz – spécial béton très dur						
Trak-It® C4 XH spik och bränslecell – för hård betong						
Type	Art. Nr.					
C4-17MM-XH	65155	700+1	3500+5	17	6,3	3,0
C4-19MM-XH	65055	700+1	3500+5	19	6,3	3,0
C4-22MM-XH	65060	700+1	3500+5	22	6,3	3,0
C4-27MM-XH	65065	700+1	3500+5	27	6,3	3,0
C4-32MM-XH	65067	700+1	3500+5	32	6,3	3,0
C4-38MM-XH	65069	700+1	3500+5	38	6,3	3,0





Trak-It® C4

The gas tool that can shoot the longest nail in concrete and steel
De gasschietamer die de langste nagel schiet in beton en staal
Das Gasnagelgerät, das die längsten Nägel in Beton und Stahl setzt
Le cloueur qui fixe les clous les plus longs dans du béton et de l'acier
Gasverktøy som skjuter dom längsta spikarna i betong och stål på marknaden



The Trak-It® C4 is the first gas nailing system with an ETA approval according to CUAP 06.01/28. No pre-drilling necessary.



VHT approval for deflection head and track-to-concrete

FORCED ENTRY

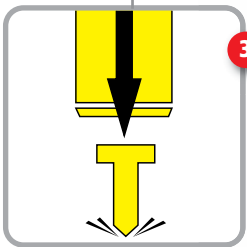

Most powerful gasnailer in the market: 150 Joules

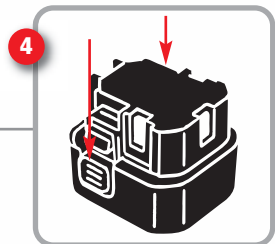

Double grip rechargeable battery for 5700 shots

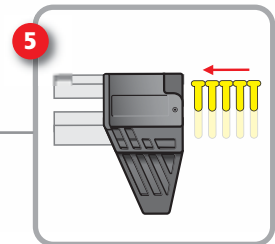

Magazine capacity for 40 nails

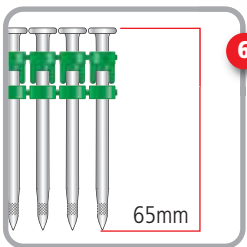

Longest nails for any gasnailer: up to 65mm. Nail diameter from 2,6 to 3,7 mm

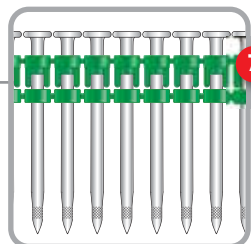

HD nails for extreme shear loads

Trak-It® C5

Keep on shooting!
 Blijft schieten wanneer anderen afhaken!
 Nageln ohne Grenzen!
 Clouer sans fin!
 Bäst i klassen , keep on shooting

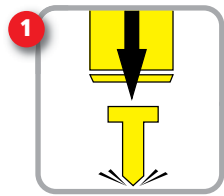

1 Most powerful gasnailer in its category: 112 Joules



2 Easy depth adjustment dial



3 Most compact tool on the market: extreme maneuverability



4 The Trak-It® C5 is the first gas nailing system with an ETA approval according to CUAP 06.01/28. No-pre-drilling necessary.

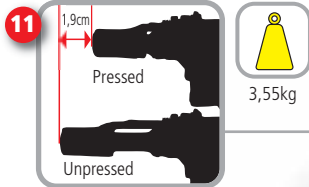

11 Lightweight (3,55kg) and shortest contact arm in the market (1,9cm): less fatigue



10 Swing trigger for easier action

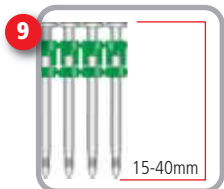

9 Shoots 15mm-40mm nails with a diameter from 2,6mm to 3,7mm



5 Best dust protection - less maintenance with new metal mesh suction filter



6 Service indicator light

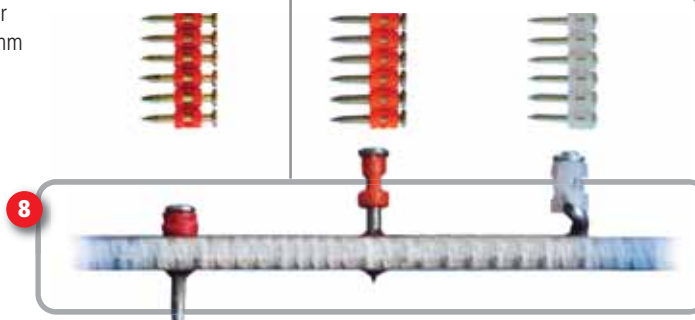

8 New Powers C5-XH nail

Nail and tool competitor O

Nail and tool competitor R



7 Single action magazine change

FORCED ENTRY





Trak-It® C5 Trak-It® C5-ST

112 Joules for 15mm-40mm nails in concrete
 112 Joules voor 15mm-40mm nagels in beton
 112 Joules für 15mm-40mm Nägel in Beton
 112 Joules pour des clous de 15mm-40mm dans le béton
 Kraftpaket 112 Joules för 15mm-40mm lång spik i betong

FORCED ENTRY

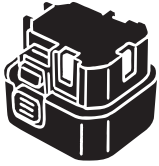

55583

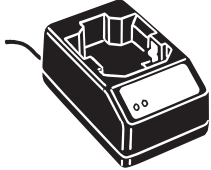

55638

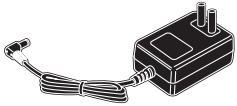

55620



55639



C5-LT 65300



C5-ST 65305



Brochure - powerseurope.com

252



112 Joules



C5 - 3,65kg
C5-ST - 3,55kg



L_{WA} = 113dB
L_{PA} = 105dB



15-40mm



Ø2,6mm
Ø3,0mm
Ø3,7mm



C5 - 40
C5-ST - 20



Max. 900
fixings



x2 (6V, 1.5Ah)
5700 fixings
per battery



Max.
150 min



C5
L 372mm
W 124mm
H 435mm



C5-ST
L 372mm
W 124mm
H 340mm



56344

56346

55000

Trak-It® C5 gastool

Trak-It® C5 gasschiethamer

Trak-It® C5 Gasnagelgerät

Trak-It® C5 cloueur à gaz

Trak-It® C5 spikpistol

Type	Art. Nr.	
TI-C5-LT NAILER	65300	1
TI-C5-ST NAILER	65305	1
12V CAR CHARGER	55639	1
BATTERY	55583	1
CHARGER BASE	55638	1
ADAPTER CORD	55620	1
PIN JAM CLEAR TOOL	55000	1
C5-LT Magazine Assembly	56344	1
C5-ST Magazine Assembly	56346	1

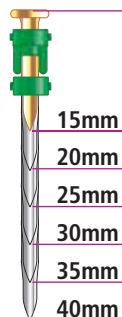
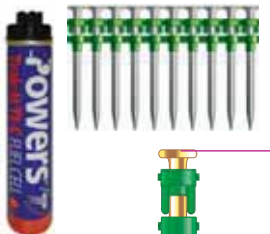

15mm
20mm
25mm
30mm
35mm
40mm

Trak-It® C5 nails and gas

Trak-It® C5 nagels en gas

Trak-It® C5 Nägel und Gas

Trak-It® C5 clous et cartouches de gaz

Trak-It® C5 spik och bränslecell

Type	Art. Nr.					
C5 TRAK-IT CAN	65310	1	100			
C5-15MM	65315	800+1	4000+5	15	6,3	2,6
C5-15MM BULKPACK	42040	8000+10	-	15	6,3	2,6
C5-20MM	65320	800+1	4000+5	20	6,3	2,6
C5-25MM	65325	800+1	4000+5	25	6,3	2,6
C5-30MM	65330	800+1	4000+5	30	6,3	2,6
C5-35MM	65335	800+1	4000+5	35	6,3	2,6
C5-40MM	65340	800+1	4000+5	40	6,3	2,6
C5-40MM BULKPACK	42048	8000+10	-	40	6,3	2,6

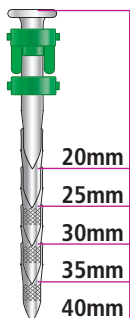
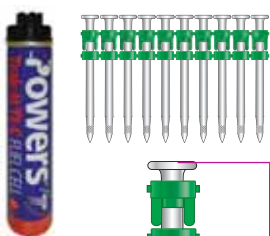

20mm
25mm
30mm
35mm
40mm

Trak-It® C5 HD nails and gas – for high shear loads

Trak-It® C5 HD nagels en gas – voor hoge afschuifwaarde

Trak-It® C5 HD Nägel und Gas – für hohe Querlasten

Trak-It® C5 HD clous et cartouches de gaz – haute performance

Trak-It® C5 HD spik och bränslecell – för höga sjuvkrafter

Type	Art. Nr.					
C5-20MM-HD	65345	800+1	4000+5	20	6,3	3,7
C5-25MM-HD	65350	800+1	4000+5	25	6,3	3,7
C5-30MM-HD	65355	800+1	4000+5	30	6,3	3,7
C5-35MM-HD	65360	800+1	4000+5	35	6,3	3,7
C5-40MM-HD	65365	800+1	4000+5	40	6,3	3,7

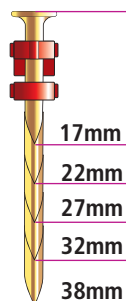

17mm
22mm
27mm
32mm
38mm

Trak-It® C5 XH nails and gas – for very hard concrete

Trak-It® C5 XH nagels en gas – voor zeer hard beton

Trak-It® C5 XH-Nägel und Gas – für sehr harten Beton

Trak-It® C5 XH clous et cartouches de gaz – spécial béton très dur

Trak-It® C5 XH spik och bränslecell – för hård betong



Type	Art. Nr.					
C5-17MM-XH	65370	800+1	4000+5	17	6,3	3,0
C5-17MM-XH BULKPACK	42042	8000+10	-	17	6,3	3,0
C5-19MM-XH	65372	800+1	4000+5	19	6,3	3,0
C5-22MM-XH	65375	800+1	4000+5	22	6,3	3,0
C5-22MM-XH BULKPACK	42044	8000+10	-	22	6,3	3,0
C5-27MM-XH	65380	800+1	4000+5	27	6,3	3,0
C5-27MM-XH BULKPACK	42046	8000+10	-	27	6,3	3,0
C5-32MM-XH	65385	800+1	4000+5	32	6,3	3,0
C5-38MM-XH	65390	800+1	4000+5	38	6,3	3,0



ETA-12/0188
22-38mm





Trak-It® C3

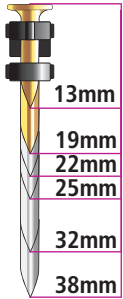
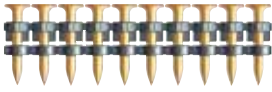

Trak-It® C3 nails and gas

Trak-It® C3 nagels en gas

Trak-It® C3 Nägel und Gas

Trak-It® C3 clous et cartouches de gaz

Trak-It® C3 spik och bränslecell

Type	Art. Nr.					
BLUE TRAK-IT CAN	55210	1	100			
C3-13MM	55102	1000+1	5000+5	13	6,3	2,6
C3-13MM BULKPACK	42014	10000+10	-	13	6,3	2,6
C3-19MM	55104	1000+1	5000+5	19	6,3	2,6
C3-22MM	55105	1000+1	5000+5	22	6,3	2,6
C3-25MM	55106	1000+1	5000+5	25	6,3	2,6
C3-32MM	55108	1000+1	5000+5	32	6,3	2,6
C3-38MM	55110	1000+1	5000+5	38	6,3	2,6
C3-38MM BULKPACK	42022	10000+10	-	38	6,3	2,6

FORCED ENTRY

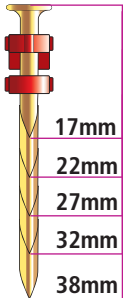
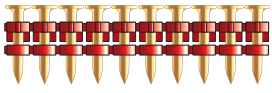

Trak-It® C3 XH nails and gas – for very hard concrete

Trak-It® C3 XH nagels en gas – voor zeer hard beton

Trak-It® C3 XH Nägel und Gas – für sehr harten Beton

Trak-It® C3 XH clous et cartouches de gaz – spécial béton très dur

Trak-It® C3 XH spik och bränslecell – för hård betong



Type	Art. Nr.					
C3-17MM-XH	55103	1000+1	5000+5	17	6,3	3,0
C3-17MM-XH BULKPACK	42016	10000+10	-	17	6,3	3,0
C3-22MM-XH	55115	1000+1	5000+5	22	6,3	3,0
C3-22MM-XH BULKPACK	42018	10000+10	-	22	6,3	3,0
C3-27MM-XH	55116	1000+1	5000+5	27	6,3	3,0
C3-27MM-XH BULKPACK	42020	10000+10	-	27	6,3	3,0
C3-32MM-XH	55117	1000+1	5000+5	32	6,3	3,0
C3-38MM-XH	55118	1000+1	5000+5	38	6,3	3,0

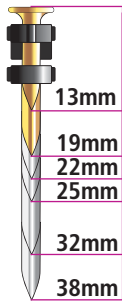

Trak-It® nails and gas for Spit® Pulsa 700
 Trak-It® nagels en gas voor Spit® Pulsa 700
 Trak-It® Nägel und Gas für Spit® Pulsa 700
 Trak-It® clous et cartouches de gaz pour Spit® Pulsa 700
 Trak-It® spik och bränslecell för Spit® Pulsa 700



Type	Art. Nr.					
700 GAS	55205	1	100			
TI700-13MM	55120	1000+2	5000+10	13	6,3	2,6
TI700-13MM BULKPACK	42024	10000+20	-	13	6,3	2,6
TI700-19MM	55122	1000+2	5000+10	19	6,3	2,6
TI700-22MM	55123	1000+2	5000+10	22	6,3	2,6
TI700-25MM	55124	1000+2	5000+10	25	6,3	2,6
TI700-32MM	55126	1000+2	5000+10	32	6,3	2,6
TI700-38MM	55128	1000+2	5000+10	38	6,3	2,6
TI700-38MM BULKPACK	42032	10000+20	-	38	6,3	2,6

FORCED ENTRY

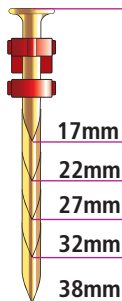

Trak-It® XH nails for Spit® Pulsa 700 – for very hard concrete
 Trak-It® XH nagels voor Spit® Pulsa 700 – voor zeer hard beton
 Trak-It® XH-Nägel für Spit® Pulsa 700 – für sehr harten Beton
 Trak-It® XH clous et cartouches de gaz pour Spit® Pulsa 700 – spécial béton très dur
 Trak-It® XH spik och bränslecell för Spit® Pulsa 700 – för hård betong



Type	Art. Nr.					
TI700-17MM-XH	55121	1000+2	5000+10	17	6,3	3,0
TI700-17MM-XH BULKPACK	42026	10000+20	-	17	6,3	3,0
TI700-22MM-XH	55125	1000+2	5000+10	22	6,3	3,0
TI700-22MM-XH BULKPACK	42028	10000+20	-	22	6,3	3,0
TI700-27MM-XH	55127	1000+2	5000+10	27	6,3	3,0
TI700-27MM-XH BULKPACK	42030	10000+20	-	27	6,3	3,0
TI700-32MM-XH	55130	1000+2	5000+10	32	6,3	3,0
TI700-38MM-XH	55132	1000+2	5000+10	38	6,3	3,0





Trak-It®

Stick-E - Just one hand needed !
 Stick-E - Slechts één hand nodig!
 Stick-E - Einhändig zu verarbeiten!
 Stick-E - Besoin d'une seule main !
 Stick-E - Monteras enkelt med bara en hand!



FORCED ENTRY

Trak-It® accessories

Trak-It® accessoires

Trak-It® Zubehör

Trak-It® accessoires

Trak-It® tillbehör



Type	Art. Nr.					
ST-LW-25MM	55040	100	1000	25		
ST-INS-36MM	55042	100	1000	36		
ST-LW-13MM	55062	100	1000	13		
ST-CBL-TIE-25MM	55076	100	1000	25		
ST-ROD-6MM	55330	100	1000		6	
ST-EYE-CLIP	55077	100	1000			
TILW-PULSA-LW	55012	100	1000	25		
ST-PLW-36MM	55070	700	7000	36		
PERFOBAND12MMx10M	65080	1	10	5		
PERFOBAND17MMx10M	65085	1	10	7		

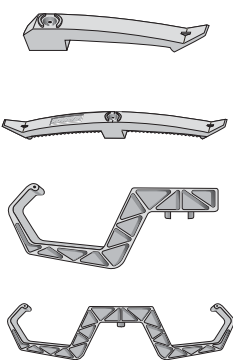

Type	Art. Nr.			NYM 3x1,5 ²
CBL-BOW-SNGL	65000	100		max. 8
CBL-BOW-DBL	65003	50		max. 16
CBL-HLDR-20	65204	50	50	max. 20
CBL-HLDR-DBL-20	65206	25	25	max. 40



55402 - 55406

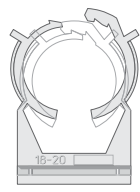

55400 - 55450



55250 - 55280

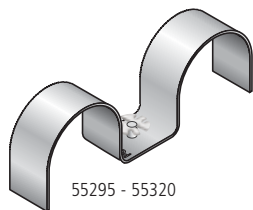

55295 - 55320



55340 - 55370

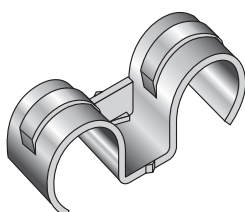

55372 - 55376

Trak-It® Quick-Clip plastic clips – halogen free
 Trak-It® Quick-Clip klembeugels – halogeenvrij
 Trak-It® Quick-Clip Klemmschellen – halogenfrei
 Trak-It® Quick-Clip attaches plastiques – sans halogène
 Trak-It® Quick-Clip plastclips – halogen fri



Type	Art. Nr.			
QKCLPII14-18	55402	100	600	14-18
QKCLPII20-25	55404	50	450	20-25
QKCLPII26-32	55406	50	300	26-32
QKCLP15-16	55400	100	900	15-16
QKCLP18-20	55410	100	900	18-20
QKCLP22-25	55420	100	600	22-25
QKCLP26-28	55430	100	600	26-28
QKCLP30-32	55440	100	100	30-32
QKCLP35-40	55450	100	100	35-40

Trak-It® conduit clips single and double
 Trak-It® haakbeugels enkel en dubbel
 Trak-It® Rohrschellen einzeln und doppelt
 Trak-It® crochets simples simples et doubles
 Trak-It® rörclips enkel och dubbelt



Type	Art. Nr.	Type	Art. Nr.			
ST-COND-13	55250			250	500	13
ST-COND-16	55255	ST-COND-16-DBL	55295	250	500	16
ST-COND-18	55260	ST-COND-18-DBL	55300	250	500	18
ST-COND-20	55265	ST-COND-20-DBL	55305	250	500	20
ST-COND-22	55270	ST-COND-22-DBL	55310	250	500	22
ST-COND-24	55275	ST-COND-24-DBL	55315	250	500	24
ST-COND-28	55280	ST-COND-28-DBL	55320	250	500	28

Trak-It® conduit clips plastic single and double - halogenfree
 Trak-It® haakbeugels plastic enkel en dubbel - halogeenvrij
 Trak-It® Rohrschellen Plastik einzeln und doppelt - halogenfrei
 Trak-It® crochets plastiques simples et doubles - sans halogène
 Trak-It® rörclips plast enkel och dubbelt - halogen fri



Type	Art. Nr.			
CLIP-PL 16MM	55340	100	900	16
CLIP-PL 18MM	55345	100	900	18
CLIP-PL 20MM	55350	100	600	20
CLIP-PL 22MM	55355	100	600	22
CLIP-PL 25MM	55360	100	600	25
CLIP-PL 28MM	55365	100	600	28
CLIP-PL 32MM	55370	50	450	32
CLIP-PL 16-19MM DBL	55372	250	250	16-19
CLIP-PL 20-23MM DBL	55375	250	250	20-23
CLIP-PL 25-28MM DBL	55376	250	250	25-28

FORCED ENTRY





P3X

Universal powder actuated tool for many applications
 Universele kruitschiethamer voor zeer veel toepassingen
 Vielseitig inzetbares automatisch Bolzensetzgerät
 Cloueur à poudre universel pour de nombreuses applications
 Hållbar och låg kostnad



FORCED ENTRY

2,88kg L 455mm 15-60mm

PDLYEL
 PDLRED

P3X powder actuated tool with magazine			
P3X kruitschiethamer met magazijn			
P3X vollautomatisches Bolzensetzgerät			
P3X cloueur à poudre avec chargeur			
P3X bultpistol med magasin			
Type	Art. Nr.		
P3X Deluxe Tool Kit	52010	1	

Powder loads in disk for Powers P3X and Spit® P370				
Kruitpatronen in disk voor Powers P3X en Spit® P370				
Rundkartuschen für Powers P3X und Spit® P370				
Charges propulsives sur disque pour Powers P3X et Spit® P370				
Patroner på skiva för Powers P3X och Spit® P370				
Type	Art. Nr.			
PDLYEL 10MM	50536	100	1000	4
PDLRED 10MM	50558	100	1000	6



Nails in strip for Powers P3X and Spit® P370 with magazine (incl.1 rubber spring per box)						
Nagels in strip passend voor Powers P3X en Spit® P370 met magazijn (incl.1 veer per box)						
Nägler magaziniert für Powers P3X und Spit® P370 mit Magazin (inkl.1 Rückschlagfeder pro box)						
Clous en bande pour Powers P3X et Spit® P370 avec chargeur (incl.1 ressort par boîte)						
Magasinerad skjutspik för Powers P3X och Spit® P370 med magasin (inkl.1 fjäder per box)						
Type	Art. Nr.					
P3X-SC9-15MM	22350	500+1	2500+5	15	8,6	3,7
P3X-SC9-20MM	22355	500+1	2500+5	20	8,6	3,7
P3X-SC9-25MM	22360	500+1	2500+5	25	8,6	3,7
P3X-SC9-30MM	22365	500+1	2500+5	30	8,6	3,7
P3X-SC9-35MM	22370	500+1	2500+5	35	8,6	3,7
P3X-SC9-40MM	22375	300+1	1500+5	40	8,6	3,7
P3X-SC9-50MM	22380	300+1	1500+5	50	8,6	3,7
P3X-SC9-60MM	22385	300+1	1500+5	60	8,6	3,7
P3X-RBBER-SPRING	22390	1	1			



P3500

Durable and low cost
 Duurzaam en voordelig
 Langlebig und preisgünstig
 Durable et prix bas
 Hållbar och låg kostnad

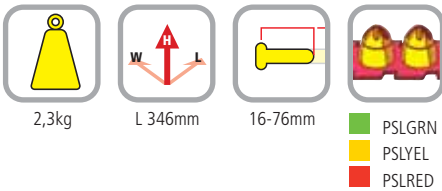
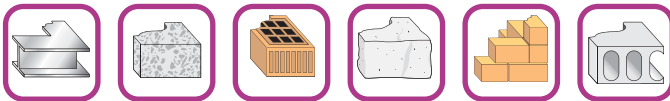
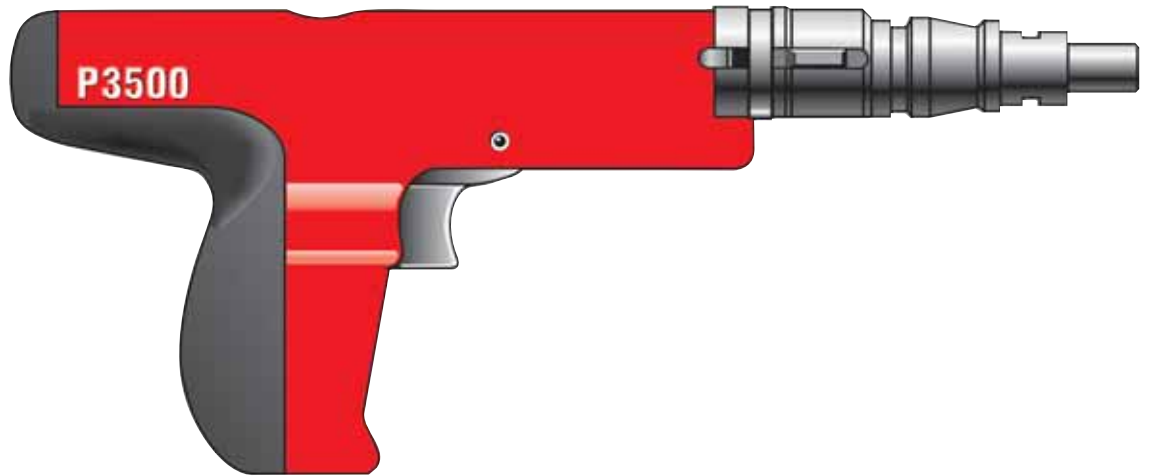

2,3kg

L 346mm

16-76mm

PSLGRN
 PSLYEL
 PSLRED

FORCED ENTRY

P3500 powder actuated tool

P3500 kruitschiethamer

P3500 Bolzensetzgerät

P3500 cloueur à poudre

P3500 bultpistol

Type	Art. Nr.	
P3500 Deluxe Tool Kit	52000	1







Powder loads in strip for Powers P3500, PA351, P450 and Hilti® DX351, DX460, DX462

Kruitpatronen in strip voor Powers P3500, PA351, P450 en Hilti® DX351, DX460, DX462

Streifenkartuschen für Powers P3500, PA351, P450 und Hilti® DX351, DX460, DX462

Charges propulsives en bandes pour Powers P3500, PA351, P450 et Hilti® DX351, DX460, DX462

Patroner i plastband för Powers P3500, PA351, P450 och Hilti® DX351, DX460, DX462

Type	Art. Nr.		
 PSLGRN	50622	100	1000
 PSLYEL	50626	100	1000
 PSLRED	50630	100	1000





P3500

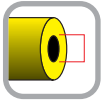

Ø7 - Ø10mm



Pins for P3X/P3500/TS750P/TS60P/S75A/S75/DX350/BETO200/P200/P60

P-nagels voor P3X/P3500/TS750P/TS60P/S75A/S75/DX350/BETO200/P200/P60

Kopfbolzen für P3X/P3500/TS750P/TS60P/S75A/S75/DX350/BETO200/P200/P60

Clous pour P3X/P3500/TS750P/TS60P/S75A/S75/DX350/BETO200/P200/P60

Skjutspik för P3X/P3500/TS750P/TS60P/S75A/S75/DX350/BETO200/P200/P60

Type	Art. Nr.			Q1 2013				
P16	50016	100	5000	3200	7-10	16	7,6	3,7
P19	50022	100	5000	3200	7-10	19	7,6	3,7
P25	50026	100	5000	3200	7-10	25	7,6	3,7
P27	50030	100	1000	3200	7-10	27	7,6	3,7
P32	50032	100	1000	1600	7-10	32	7,6	3,7
P38	50034	100	1000	1600	7-10	38	7,6	3,7
P44	50036	100	1000	1600	7-10	44	7,6	3,7
P51	50038	100	1000	1600	7-10	51	7,6	3,7
P57	50040	100	1000	1600	7-10	57	7,6	3,7
P64	50044	100	1000	1600	7-10	64	7,6	3,7
P70	50046	100	1000	800	7-10	70	7,6	3,7
P76	50048	100	1000	800	7-10	76	7,6	3,7

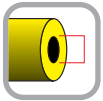

Ø7 - Ø10mm



Ballistic point pins for harder base materials (P3X/P3500/TS750P/TS60P/S75A/S75/DX350/BETO200/P200/P60)

Nagels met ballistische punt voor harder basismateriaal (P3X/P3500/TS750P/TS60P/S75A/S75/DX350/BETO200/P200/P60)

Kopfbolzen mit ballistischer Spitze für härtere Baustoffe (P3X/P3500/TS750P/TS60P/S75A/S75/DX350/BETO200/P200/P60)

Clous à pointe balistique pour des matériaux de base plus solides (P3X/P3500/TS750P/TS60P/S75A/S75/DX350/BETO200/P200/P60)

Spik med ballistisk spets för hårda material (P3X/P3500/TS750P/TS60P/S75A/S75/DX350/BETO200/P200/P60)

Type	Art. Nr.			Q1 2013				
P13HC	50052	100	1000	3200	7-10	13	7,6	3,7
P19HC	50054	100	1000	3200	7-10	19	7,6	3,7

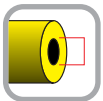

Ø7 - Ø10mm



Head drive pins with top hat for P3X/P3500/TS750P/TS60P/S75A/S75/DX350/BETO200/P200/P60

Nagels met ring voor P3X/P3500/TS750P/TS60P/S75A/S75/DX350/BETO200/P200/P60

Kopfbolzen mit Scheibe für P3X/P3500/TS750P/TS60P/S75A/S75/DX350/BETO200/P200/P60

Clous avec amortisseur d'énergie pour P3X/P3500/TS750P/TS60P/S75A/S75/DX350/BETO200/P200/P60

Skjutspik med bricka för P3X/P3500/TS750P/TS60P/S75A/S75/DX350/BETO200/P200/P60

Type	Art. Nr.			Q1 2013				
P16TH	50138	100	5000	3200	7-10	16	7,6	3,7
P25TH	50144	100	5000	3200	7-10	25	7,6	3,7

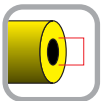

Ø7 - Ø10mm



Washer head drive pins for P3X/P3500/TS750P/TS60P/S75A/S75/DX350/BETO200/P200/P60

Nagel met onderlegschiif voor P3X/P3500/TS750P/TS60P/S75A/S75/DX350/BETO200/P200/P60

Kopfbolzen mit Rondelle für P3X/P3500/TS750P/TS60P/S75A/S75/DX350/BETO200/P200/P60

Clous avec rondelle pour P3X/P3500/TS750P/TS60P/S75A/S75/DX350/BETO200/P200/P60

Skjutspik med isolerbricka för P3X/P3500/TS750P/TS60P/S75A/S75/DX350/BETO200/P200/P60

Type	Art. Nr.			Q1 2013					
P25W	50090	100	1000	800	7-10	25	7,6	3,7	22
P37W	50094	100	1000	800	7-10	37	7,6	3,7	22

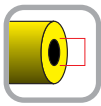

Ø7 - Ø10mm

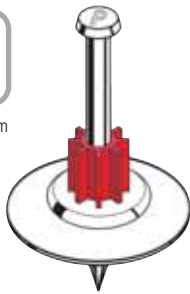

Drive pins with insulation washer for P3X/P3500/TS750P/TS60P/S75A/S75/DX350/BETO200/P200/P60

Nagel met isolatierondel voor P3X/P3500/TS750P/TS60P/S75A/S75/DX350/BETO200/P200/P60

Kopfbolzen mit Rondelle für P3X/P3500/TS750P/TS60P/S75A/S75/DX350/BETO200/P200/P60

Clous avec rondelle pour P3X/P3500/TS750P/TS60P/S75A/S75/DX350/BETO200/P200/P60

Skjutspik med upphängningsclips för P3X/P3500/TS750P/TS60P/S75A/S75/DX350/BETO200/P200/P60

Type	Art. Nr.			Q1 2013					
P38IW	50122	100	1000	400	7-10	38	7,6	3,7	36
P51IW	50124	100	1000	200	7-10	51	7,6	3,7	36
P64IW	50126	50	500	200	7-10	64	7,6	3,7	36

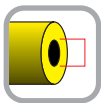

Ø7 - Ø10mm



Head pin with ceiling clip for P3X/P3500/TS750P/TS60P/S75A/S75/DX350/BETO200/P200/P60

Nagel met hangbeugel voor P3X/P3500/TS750P/TS60P/S75A/S75/DX350/BETO200/P200/P60

Kopfbolzen mit aufgestecktem Hakenbügel für P3X/P3500/TS750P/TS60P/S75A/S75/DX350/BETO200/P200/P60

Clous avec patte percée pour suspente P3X/P3500/TS750P/TS60P/S75A/S75/DX350/BETO200/P200/P60

Skjutspik med rörlips passande P3X/P3500/TS750P/TS60P/S75A/S75/DX350/BETO200/P200/P60

Type	Art. Nr.			Q1 2013					
PCC25	50368	100	1000	800	7-10	25	7,6	3,7	
PCC32	50374	100	1000	400	7-10	32	7,6	3,7	

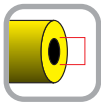

Ø7 - Ø10mm

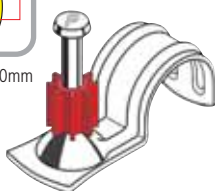

Drive pins with conduit clips for P3X/P3500/TS750P/TS60P/S75A/S75/DX350/BETO200/P200/P60

Nagel met haakbeugel voor P3X/P3500/TS750P/TS60P/S75A/S75/DX350/BETO200/P200/P60

Kopfbolzen mit aufgesteckter Rohrschelle für P3X/P3500/TS750P/TS60P/S75A/S75/DX350/BETO200/P200/P60

Clous avec crochet pour P3X/P3500/TS750P/TS60P/S75A/S75/DX350/BETO200/P200/P60

Skjutspik med rörlips passande P3X/P3500/TS750P/TS60P/S75A/S75/DX350/BETO200/P200/P60

Type	Art. Nr.			Q1 2013	Q1 2013					
PCOND13	50381	100	1000	200	400	7-10	25	7,6	3,7	13
PCOND19	50385	100	500	200	400	7-10	25	7,6	3,7	19
PCOND26	50387	25	250	100	200	7-10	25	7,6	3,7	26
PCOND32	50392	100	1000	100	200	7-10	25	7,6	3,7	32



HD steel pin for P3X/P3500/DXA40/DXA41/DX460/DX350

HD staalnagel voor P3X/P3500/DXA40/DXA41/DX460/DX350

Kopfbolzen für Stahl für P3X/P3500/DXA40/DXA41/DX460/DX350

HD clou à tête pour P3X/P3500/DXA40/DXA41/DX460/DX350

Skjutspik för stålprofil passande P3X/P3500/DXA40/DXA41/DX460/DX350

Type	Art. Nr.			Q1 2013					
PHD1612	22100	100	1000	3200	16	7,6	3,7	12	

FORCED ENTRY





P450

The classic for NK nails
 De klassieker voor NK nagels
 Der Klassiker für NK-Nägels
 Le classique pour NK clous
 Klassiker für NK-Nägels



FORCED ENTRY

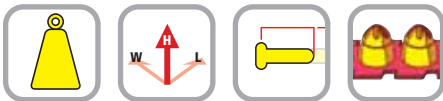
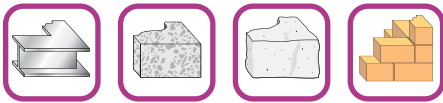

3,2kg

L 350mm

16-97mm

- PSLGRN
- PSLYEL
- PSLRED
- PSLBLK

P450 powder actuated tool

P450 kruitschiethamer

P450 Bolzensetzgerät

P450 cloueur à poudre

P450 bułtpistol



Type	Art. Nr.	
P450 Deluxe Tool Kit	52005	1



Powderloads in strip for Powers P3500, PA351, P450 and Hilti® DX351, DX460, DX462

Kruitpatronen in strip voor Powers P3500, PA351, P450 en Hilti® DX351, DX460, DX462

Streifenkartuschen für Powers P3500, PA351, P450 und Hilti® DX351, DX460, DX462

Charges propulsives en bandes pour Powers P3500, PA351, P450 et Hilti® DX351, DX460, DX462

Patroner i plastband för Powers P3500, PA351, P450 och Hilti® DX351, DX460, DX462

Type	Art. Nr.			
PSLGRN	50622	100	1000	3
PSLYEL	50626	100	1000	4
PSLRED	50630	100	1000	6
PSLBLK*	20005	100	1000	7

* Not suitable for Powers P3500 and PA351

* Niet geschikt voor Powers P3500 en PA351

* Nicht geeignet für Powers P3500 und PA351

* Ne convient pas pour Powers P3500 et PA351

* Inte lämpar sig för Powers P3500 och PA351



NK pins fitting for P450/DX450

NK nagels passend voor P450/DX450

Kopfbolzen für P450/DX450

NK clous a tête pour P450/DX450

NK skjutspik passande P450/DX450

Type	Art. Nr.							
				Q1 2013				
NK16S	22505	100	1000	3200	11,8	16	5,6	3,7
NK19S	22510	100	1000	3200	11,8	19	5,6	3,7
NK22	22515	100	1000	3200	11,8	22	5,6	3,7
NK27	22520	100	1000	3200	11,8	27	5,6	3,7
NK32	22525	100	1000	3200	11,8	32	5,6	3,7
NK37	22530	100	1000	1600	11,8	37	5,6	3,7
NK42	22535	100	1000	1600	11,8	42	5,6	3,7
NK47	22537	100	1000	1600	11,8	47	5,6	3,7
NK54	22540	100	1000	1600	11,8	54	5,6	3,7
NK62	22545	100	1000	800	11,8	62	5,6	3,7
NK72	22550	100	1000	800	11,8	72	5,6	3,7
NK82	22555	100	1000	800	11,8	82	5,6	3,7
NK92	22560	100	1000	800	11,8	92	5,6	3,7
NK97	22565	100	1000	800	11,8	97	5,6	3,7





PA351 nails









DN nails in strip for Powers PA351 (until 42mm) and Hilti® DXA40/DXA41/DX460

DN nagels in strip voor Powers PA351 (tot 42mm) en Hilti® DXA40/DXA41/DX460

Kopfbolzen magaziniert für Powers PA351 (bis 42mm) und Hilti® DXA40/DXA41/DX460

DN clous en bande pour Powers PA351 (jusqu'à 42mm) et Hilti® DXA40/DXA41/DX460

DN magasinerad skjutspik för Powers PA351 (till 42mm) och Hilti® DXA40/DXA41/DX460

Type	Art. Nr.						
				Q1 2013			
DN16M	22005	100	1000	3200	16	7,8	3,7
DN19M	22010	100	1000	3200	19	7,8	3,7
DN22M	22015	100	1000	3200	22	7,8	3,7
DN27M	22020	100	1000	3200	27	7,8	3,7
DN32M	22025	100	1000	3200	32	7,8	3,7
DN37M	22030	100	1000	3200	37	7,8	3,7
DN42M	22035	100	1000	1600	42	7,8	3,7
DN47M	22040	100	1000	1600	47	7,8	3,7
DN52M	22045	100	1000	1600	52	7,8	3,7
DN62M	22050	100	1000	1600	62	7,8	3,7
DN72M	22055	100	1000	1600	72	7,8	3,7

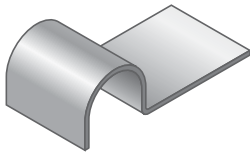

Conduit clips metal				
Haakbeugels metaal				
Rohrschellen Metall				
Crochet métal				
Rörclips metall				
Type	Art. Nr.			
TICOND12MM	55202	100	1000	12
TICOND16MM	55203	100	1000	16
TICOND18MM	55204	100	1000	18
TICOND20MM	63200	100	1000	20
TICOND22MM	63205	100	1000	22
TICOND24MM	63210	100	1000	24
TICOND25MM	55206	100	1000	25
TICOND28MM	63215	100	1000	28
TICOND32MM	55208	100	1000	32

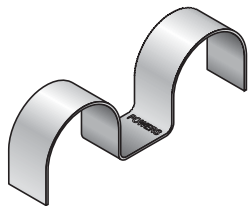

Conduit clips double metal				
Haakbeugels dubbel metaal				
Rohrschellen doppelt Metall				
Crochet double métal				
Rörclips dubbelt metall				
Type	Art. Nr.			
TICOND-DBL16MM	63220	100	1000	16
TICOND-DBL20MM	63225	50	500	20
TICOND-DBL22MM	63230	50	500	22
TICOND-DBL24MM	63235	50	500	24
TICOND-DBL28MM	63240	50	500	28





	NAIL-IT W3-34CDH	NAIL-IT W3-21FRH
Timber framing	Roofer & General construction	Roofer & General construction
Hout-op-hout bevestiging	Dakdekker & Aannemer	Dakdekker & Aannemer
Holz auf Holz	Dachdecker & Innenausbau	Dachdecker & Innenausbau
Bois sur bois	Charpentier & Entrepreneur général	Charpentier & Entrepreneur général
Trä skjutmontage	Taktäckare & allmänna konstruktioner	Taktäckare & allmänna konstruktioner
Page/ Pagina/ Seite / Page/ Sida	52	54
Impact strength in Joule Slagkracht in Joule Einschlagstärke in Joule Energie impact en Joule Energi / slagkraft i Joule	95 J	95 J
Weight in kg Gewicht in kg Gewicht in kg Poids en kg Vikt i kg	3,5kg	3,5kg
Type of collation Type strip Bindung Type de bandage Spik / Bandning typ	34° Paper / Papier / Papper 	21° Plastic / Plastik / Plastique / Plast
Head type Kopsoort Kopfform Forme de tête Spikhuvud		
Nail length and diameter Nagellengte en diameter Nagellänge und Durchmesser Longueur de clou et diamètre Spiklängd och diameter	51mm - 90mm Ø2,8mm - Ø3,1mm 	51mm - 90mm Ø2,8mm - Ø3,1mm

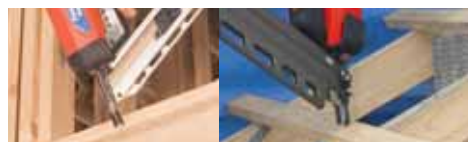

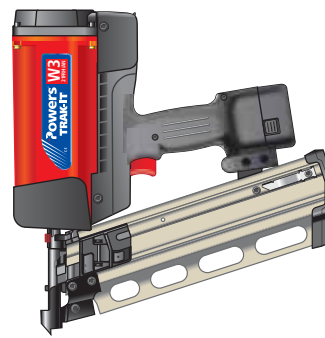

Q4 2013

NAIL-IT W3-21FRH-HAFT

Roofer, General construction & Zinc worker

Dakdekker, Aannemer & Zinkwerker

Dachdecker, Innenausbau & Spengler

Charpentier, Entrepreneur général & Zingueur

Taktäckare, Allmänna konstruktioner & Mässing/zink tak

54

95 J

3,6kg

21° Plastic / Plastik / Plastique / Plast



25mm Ø2,8mm



51mm - 90mm Ø2,8mm - Ø3,1mm

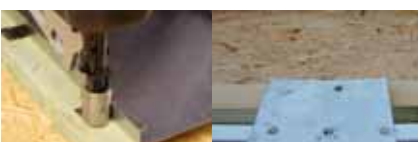
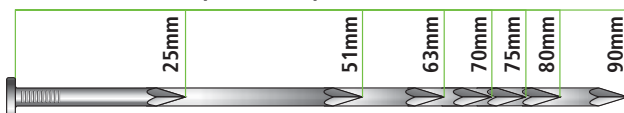

Nail-It W3-21FRH/AN

Roofer & Carpenter

Dakdekker & Timmerman

Dachdecker & Zimmermann

Charpentier & Poseur d'ardoises

Taktäckare & Snickare

56

95 J

3,6kg

21° Plastic / Plastik / Plastique / Plast



40 - 60mm Ø4,0mm



FORCED ENTRY





Nail-It W3-34CDH

For 34° paper collated D-head nails on strip
 Voor 34° papiergebonden D-kopnagels op strip
 Für 34° D-Kopfnägel auf Papierstreifen
 Pour 34° D-tête clous sur bande papier
 För 34° D-huvud pappersbandad spik



FORCED ENTRY

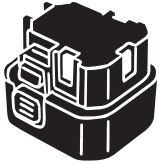

55583

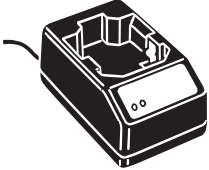

55638

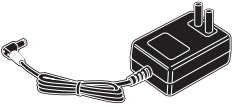

55620



55639



95 Joules



3,5kg



L_{WA}: 105 dB
L_{pA}: 98 dB



34°



50mm-
90mm



Ø2,8mm-
Ø3,1mm

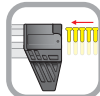

40



Max. 1200
fixings



x2 (6V, 1.5Ah)
5700 fixings
per battery



Max.
150 min



L 340mm
W 110mm
H 391mm



Nail-It W3-34CDH gastool for wood – for 34° paper collated D-head nails on strip

Nail-It W3-34CDH gasschiethamer voor hout – voor 34° papiergebonden D-kopnagels op strip

Nail-It W3-34CDH Gasnagelgerät für Holz – für 34° D-Kopfnägel auf Papierstreifen

Nail-It W3-34CDH cloueur à gaz pour bois – pour 34° D-tête clous sur bande papier

Nail-It W3-34CDH spikpistol för trä – för 34° D-huvud pappersbandad spik



Type	Art. Nr.		
NAIL-IT W3-34CDH	55021	1	
CONTACT TOP NAIL-IT	60019	1	
12V CAR CHARGER	55639	1	
BATTERY	55583	1	
CHARGER BASE	55638	1	
ADAPTER CORD	55620	1	

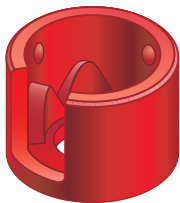

60019

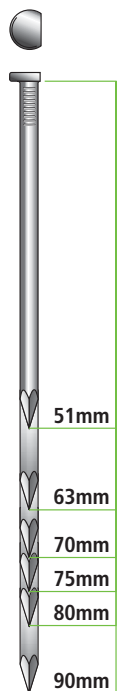

Nail-It W3-34CDH nails and gas – D-head, 34°, paper collated strip
 Nail-It W3-34CDH nagels en gas – D-kop, 34°, papiergebonden strip
 Nail-It W3-34CDH Nägel und Gas – D-Kopf, 34°, Papierstreifen
 Nail-It W3-34CDH clous et cartouches de gaz – D-tête, 34°, sur bande papier
 Nail-It W3-34CDH spik och bränslecell – D-huvud, 34°, papperbandad

Type	Art. Nr.					
RED CAN	55212	1	100			

Smooth – bright / Glad – niet verzinkt / Glatt – blank / Lisses / Slät – blank						
DH51x28-S-BR	62010	3300+3		237.600	51	2,8
DH63x28-S-BR	62055	3300+3		237.600	63	2,8
DH70x28-S-BR	62106	2200+2		158.400	70	2,8
DH75x28-S-BR	62110	2200+2		158.400	75	2,8
DH80x31-S-BR	62158	2200+2		158.400	80	3,1
DH80x28-S-BR	62169	2200+2		158.400	80	2,8
DH90x31-S-BR	62170	2200+2		158.400	90	3,1

Ring – bright / Ring – niet verzinkt / Ring – blank / Crantés / Ring – blank						
DH51x28-R-BR	62020	3300+3		237.600	51	2,8
DH63x28-R-BR	62075	3300+3		237.600	63	2,8
DH70x28-R-BR	62108	2200+2		158.400	70	2,8
DH75x28-R-BR	62120	2200+2		158.400	75	2,8
DH75x31-R-BR	62130	2200+2		158.400	75	3,1
DH80x28-R-BR	62161	2200+2		158.400	80	2,8

Smooth – zinc plated / Glad – verzinkt / Glatt – verzinkt / Lisses – zingué / Slät – elförzinkad						
DH51x28-S-EL	62015	3300+3		237.600	51	2,8
DH63x28-S-EL	62065	3300+3		237.600	63	2,8
DH75x28-S-EL	62115	2200+2		158.400	75	2,8
DH80x31-S-EL	62160	2200+2		158.400	80	3,1
DH90x31-S-EL	62180	2200+2		158.400	90	3,1

Ring – zinc plated / Ring – verzinkt / Ring – verzinkt / Crantés – zingué / Ring – elförzinkad						
DH51x28-R-EL	62030	3300+3		237.600	51	2,8
DH63x28-R-EL	62085	3300+3		237.600	63	2,8
DH70x28-R-EL	62107	2200+2		158.400	70	2,8
DH75x28-R-EL	62138	2200+2		158.400	75	2,8
DH75x31-R-EL	62140	2200+2		158.400	75	3,1
DH80x28-R-EL	62163	2200+2		158.400	80	2,8
DH90x31-R-EL	62165	2200+2		158.400	90	3,1

Smooth – hot dip galvanised / Glad – termisch verzinkt / Glatt – feuerverzinkt / Lisses – galvanisé à chaud / Slät – varmförzinkad						
DH90x31-S-HD	62190	2200+2		158.400	90	3,1

Ring – hot dip galvanised / Ring – termisch verzinkt / Ring – feuerverzinkt / Crantés – galvanisé à chaud / Ring – varmförzinkad						
DH63x28-R-HD	62095	3300+3		237.600	63	2,8
DH75x31-R-HD	62150	2200+2		158.400	75	3,1

Ring – A2 steel / Ring – A2 staal / Ring – A2 Edelstahl / Crantés – acier A2 / Ring – A2 stål						
DH51x28-R-SS	62040	3300+3		237.600	51	2,8
DH63x28-R-SS	62105	3300+3		237.600	63	2,8

FORCED ENTRY





W3-21 FRH W3-21 FRH/HAFT

For brass/zinc rooftops and wood on wood
Voor koperen/zinken daken en hout op hout
Für Haften (Blech/Zink-Dächer) und Holz auf Holz
Pour toits en cuivre / zinc et bois sur bois
För mässing / zink tak, 2 maskiner i en och trä skjutmontage



FORCED ENTRY

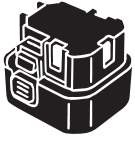

55583

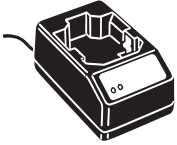

55638

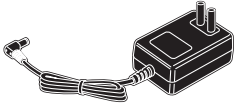

55620



55639



55019

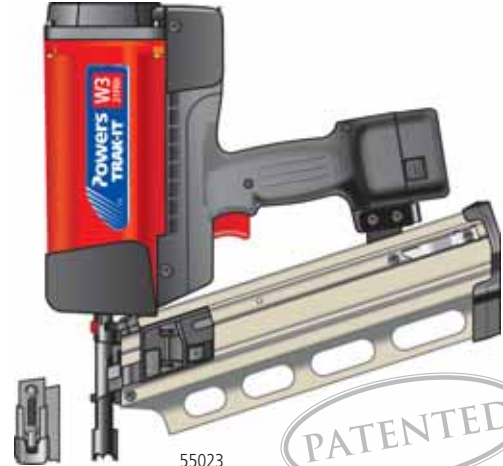

55023



95 Joules



FRH: 3,5kg
FRH/HAFT: 3,6kg



L_{WA}: 105 dB
L_{pA}: 98 dB



21°



FRH:
50mm-
90mm

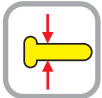

FRH:
Ø2,8mm-
Ø3,1mm

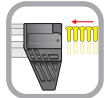

FRH: 26
FRH/HAFT: 38



Max. 1200
fixings



x2 (6V, 1.5Ah)
5700 fixings
per battery



Max.
150 min



L 379mm
W 111mm
H 382mm



FRH/HAFT:
25mm
32mm

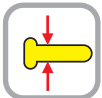

FRH/HAFT:
Ø2,8mm

W3-21FRH(HAFT) gastool for wood – for 21° plastic collated full round head nails

W3-21FRH(HAFT) gasschietamer voor hout – voor 21° plastic gebonden volrondkopnagels op strip

W3-21FRH(HAFT) Gasnagelgerät für Holz – für 21° Vollrundkopfnägel auf Plastikstreifen

W3-21FRH(HAFT) cloueur à gaz pour bois – pour 21° tête pleine sur bande plastique

W3-21FRH(HAFT) spikpistol för trä – för 21° helrunt huvud plastbandad spik



Type	Art. Nr.		
NAIL-IT W3-21FRH	55019	1	
NAIL-IT W3-21FRH/HAFT	55023	1	
CONTACT TOP NAIL-IT	60019	1	
12V CAR CHARGER	55639	1	
BATTERY	55583	1	
CHARGER BASE	55638	1	
ADAPTER CORD	55620	1	

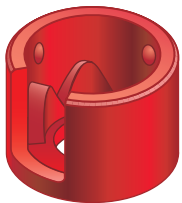

60019



W3-21FRH/HAFT nails and gas – full round head, 21°, plastic collated strip
 W3-21FRH/HAFT nagels en gas – volrondkop, 21°, plastic gebonden strip
 W3-21FRH/HAFT Nägel und Gas – Vollrundkopf, 21°, Plastikstreifen
 W3-21FRH/HAFT clous et cartouches de gaz – tête pleine, 21°, bande plastique
 W3-21FRH/HAFT spik och bränslecell – helrunt huvud, 21°, plastbandad

Type	Art. Nr.				
RED CAN	55212	1	100		

Ring – hot dip galvanised / Ring – thermisch verzinkt / Ring – feuerverzinkt / Crantés – galvanisé à chaud / Ring – varmförzinkad

FRH-HAFT25x28-R-HD	62540	2200+2	6600+6	25	2,8
Ring – A2 steel / Ring – A2 staal / Ring – A2 Edelstahl / Crantés – acier A2 / Ring – A2 stål					
FRH-HAFT25x28-R-SS	62550	2200+2	6600+6	25	2,8
FRH-HAFT32x28-R-SS	62555	2200+2	6600+6	32	2,8

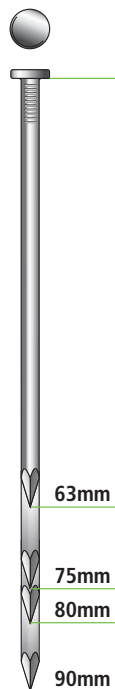
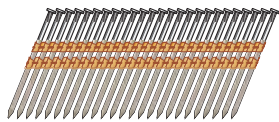

Nail-It W3-21FRH nails and gas – full round head, 21°, plastic collated strip
 Nail-It W3-21FRH nagels en gas – volrondkop, 21°, plastic gebonden strip
 Nail-It W3-21FRH Nägel und Gas – Vollrundkopf, 21°, Plastikstreifen
 Nail-It W3-21FRH clous et cartouches de gaz – tête pleine, 21°, bande plastique
 Nail-It W3-21FRH spik och bränslecell – helrunt huvud, 21°, plastbandad

Type	Art. Nr.				
RED CAN	55212	1	100		

Smooth – bright / Glad – niet verzinkt / Glatt – blank / Lisses / Slät – blank

FRH 90x31-S-BR	62435	2200+2		90	3,1
Ring – bright / Ring – niet verzinkt / Ring – blank / Crantés / Slät – blank					
FRH 63x28-R-BR	62445	3300+3		63	2,8
FRH 75x28-R-BR	62450	2200+2		75	2,8

Smooth – zinc plated / Glad – verzinkt / Glatt – verzinkt / Lisses – zingué / Slät – elförzinkad

FRH 90x31-S-EL	62485	2200+2		90	3,1
Ring – hot dip galvanised / Ring – thermisch verzinkt / Ring – feuerverzinkt / Crantés – galvanisé à chaud / Ring – varmförzinkad					
FRH 75x31-R-HD	62520	2200+2		75	3,1

Ring – zinc plated / Ring – verzinkt / Ring – verzinkt / Crantés – zingué / Ring – elförzinkad

FRH 63x28-R-EL	62495	3300+3		63	2,8
FRH 75x28-R-EL	62497	2200+2		75	2,8
FRH 80x28-R-EL	62498	2200+2		80	2,8

FORCED ENTRY





Nail-It W3-21FRH/AN nailer

Positive placement nailer for fixing joist hangers, straps, truss clips etc.
Zelfcentrerende gasschiethamer voor bevestigen van hoekverbindingen, dwarsbalkdragers, balkverbinders etc.
Ankernagel zur Befestigung von Winkelverbinder, Lochbleche, Balkenschuhe, Balkenträger etc.
Cloueur à Gaz pour sabots & équerres de charpente
Ankarspikpistol gas för spikning av byggsbeslag och spikplåt



Q4 2013

FORCED ENTRY

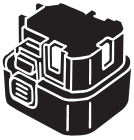

55583

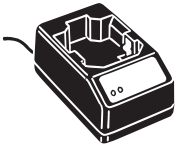

55638

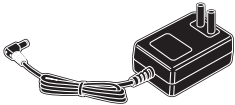

55620



55639



95 Joules



3,6kg



L_{WA}: 105 dB
L_{pA}: 98 dB



21°



FRH/AN:
40-60mm



Ø4,0mm

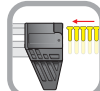

FRH: 27



Max. 1200
fixings



x2 (6V, 1.5Ah)
5700 fixings
per battery



Max.
150 min



L 379mm
W 111mm
H 382mm



W3-21FRH/AN gastool for wood - for 21° plastic collated full round head nails

W3-FRH/AN gasschiethamer voor hout - voor 21° plastic gebonden volrondkopnagels op strip

W3-21FRH/AN Gasnagelgerät für Holz - für 21° Vollrundkopfnägel auf Plastikstreifen

W3-21FRH/AN cloueur à gaz pour bois - pour 21° tête pleine sur bande plastique

W3-21FRH/AN spikpistol för trä - för 21° helrunt huvud plastbandad spik

Type	Art. Nr.		
NAIL-IT W3-21FRH-AN	55025	1	
12V CAR CHARGER	55639	1	
BATTERY	55583	1	
CHARGER BASE	55638	1	
ADAPTER CORD	55620	1	

Nail-It W3-21FRH/AN nailer



Nail-It W3-21FRH/AN nails and gas - full round head, 21°, plastic collated strip					
Nail-It W3-21FRH/AN nagels en gas - volrondkop, 21°, plastic gebonden strip					
Nail-It W3-21FRH/AN Nägel und Gas - Vollrondkopf, 21°, Plastikstreifen					
Nail-It W3-21FRH/AN clous et cartouches de gaz - tête pleine, 21°, bande plastique					
Nail-It W3-21FRH/AN spik och bränslecell - helrunt huvud, 21°, plastbandad					
Type	Art. Nr.				
Ring – zinc plated / Ring – verzinkt / Ring – verzinkt / Crantés – zingué / Ring – elförzinkad					
FRH/AN 40x40-R-EL	62007	2200+2		40	4,0
FRH/AN 50x40-R-EL	62008	2200+2		50	4,0
FRH/AN 60x40-R-EL	62009	2200+2		60	4,0

FORCED ENTRY





Nails Pneumatic

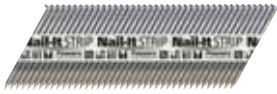

34° paper collated D-head nails fitting pneumatic tackers
 34° papiergebonden D-kopnagels passend voor pneumatische tackers
 34° D-Kopfnägel auf Papierstreifen für Druckluft-Streifennagler
 D-tête pointes d'angle 34° en bande papier pour cloueurs pneumatiques
 34° papperbandad D-huvud spik för pneumatiska häftpistoler

Type Art. Nr.

Smooth – bright / Glad – niet verzinkt / Glatt – blank / Lisses / Slät – blank

Type	Art. Nr.				
DH51x28-S-BR NO GAS	62800	3300	237.600	51	2,8
DH63x28-S-BR NO GAS	62805	3300	237.600	63	2,8
DH70x28-S-BR NO GAS	62808	2200	158.400	70	2,8
DH75x28-S-BR NO GAS	62810	2200	158.400	75	2,8
DH80x31-S-BR NO GAS	62815	2200	158.400	80	3,1
DH80x28-S-BR NO GAS	62820	2200	158.400	80	2,8
DH90x31-S-BR NO GAS	62825	2200	158.400	90	3,1

Ring – bright / Ring – niet verzinkt / Ring – blank / Crantés / Ring – blank

DH51x28-R-BR NO GAS	62830	3300	237.600	51	2,8
DH63x28-R-BR NO GAS	62835	3300	237.600	63	2,8
DH70x28-R-BR NO GAS	62848	2200	158.400	70	2,8
DH75x28-R-BR NO GAS	62840	2200	158.400	75	2,8
DH75x31-R-BR NO GAS	62845	2200	158.400	75	3,1
DH80x28-R-BR-NO GAS	62849	2200	158.400	80	2,8

Smooth – zinc plated / Glad – verzinkt / Glatt – verzinkt / Lisses – zingué / Slät – elförzinkad

DH51x28-S-EL NO GAS	62855	3300	237.600	51	2,8
DH63x28-S-EL NO GAS	62860	3300	237.600	63	2,8
DH75x28-S-EL NO GAS	62865	2200	158.400	75	2,8
DH80x31-S-EL NO GAS	62870	2200	158.400	80	3,1
DH90x31-S-EL NO GAS	62875	2200	158.400	90	3,1

Ring – zinc plated / Ring – verzinkt / Ring – verzinkt / Crantés – zingué / Ring – elförzinkad

DH51x28-R-EL NO GAS	62880	3300	237.600	51	2,8
DH63x28-R-EL NO GAS	62885	3300	237.600	63	2,8
DH70x28-R-EL NO GAS	62887	2200	158.400	70	2,8
DH75x28-R-EL NO GAS	62890	2200	158.400	75	2,8
DH75x31-R-EL NO GAS	62895	2200	158.400	75	3,1
DH80x28-R-EL NO GAS	62900	2200	158.400	80	2,8
DH90x31-R-EL NO GAS	62907	2200	158.400	90	3,1

Smooth – hot dip galvanised / Glad – termisch verzinkt / Glatt – feuerverzinkt / Lisses – galvanisé à chaud / Slät – varmförzinkad

DH90x31-S-HD NO GAS	62910	2200	158.400	90	3,1
---------------------	-------	------	---------	----	-----

Ring – hot dip galvanised / Ring – termisch verzinkt / Ring – feuerverzinkt / Crantés – galvanisé à chaud / Ring – varmförzinkad

DH63x28-R-HD NO GAS	62915	3300	237.600	63	2,8
DH75x31-R-HD NO GAS	62920	2200	158.400	75	3,1

Ring – A2 steel / Ring – A2 staal / Ring – A2 Edelstahl / Crantés – acier A2 / Ring – A2 stål

DH51x28-R-SS NO GAS	62925	3300	237.600	51	2,8
DH63x28-R-SS NO GAS	62930	3300	237.600	63	2,8

FORCED ENTRY

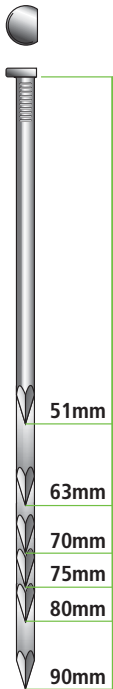

Finishing Nails

Fitting Impulse® bradnailers
 Passend voor Impulse® afwerktrackers
 Passt in Impulse® Stiftnagler
 Convient à Impulse®
 Passar Impulse® dyckertpistol

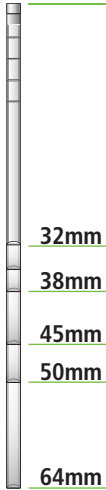
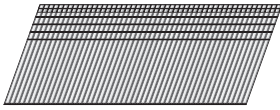

20° Angle brads and gas fitting Paslode® Impulse IM250A and IM65A F16
 20° Schuine nagels en gas passend voor Paslode® Impulse IM250A en IM65A F16
 20° Schräge Stauchkopfnägel und Gas für Paslode® Impulse IM250A und IM65A F16
 Clous de finition 20° et cartouches à gaz pour Paslode® Impulse IM250A et IM65A F16
 Dyckert snedställd 20° och bränslecell för Paslode® Impulse IM250A och IM65A F16



Type	Art. Nr.				
MINI CAN YELLOW	55220	1	100		

Zinc plated / Verzinkt / Verzinkt / Zingué / Elförzinkad					
Type	Art. Nr.				
ANGLEBRAD-32EL	62340	2000+2	12000+12	32	1,6
ANGLEBRAD-38EL	62350	2000+2	12000+12	38	1,6
ANGLEBRAD-45EL	62360	2000+2	12000+12	45	1,6
ANGLEBRAD-50EL	62370	2000+2	12000+12	50	1,6
ANGLEBRAD-64EL	62380	2000+2	12000+12	64	1,6

A2 steel / A2 staal / A2 Edeldstahl / acier A2 / A2 stål					
Type	Art. Nr.				
ANGLEBRAD-32SS	62382	2000+2	12000+12	32	1,6
ANGLEBRAD-38SS	62384	2000+2	12000+12	38	1,6
ANGLEBRAD-45SS	62385	2000+2	12000+12	45	1,6
ANGLEBRAD-50SS	62386	2000+2	12000+12	50	1,6
ANGLEBRAD-64SS	62388	2000+2	12000+12	64	1,0

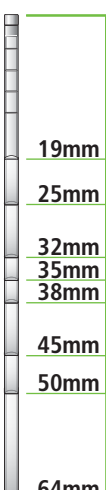
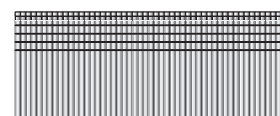

Straight brads and gas fitting Paslode® Impulse IM250 and IM65 F16
 Rechte brads en gas passend voor Paslode® Impulse IM250 en IM65 F16
 Stauchkopfnägel und Gas für Paslode® Impulse IM250 und IM65 F16
 Clous de finition et cartouches de gaz pour Paslode® Impulse IM250 et IM65 F16
 Dyckert rak och bränslecell för Paslode® Impulse IM250 och IM65 F16



Type	Art. Nr.				
MINI CAN YELLOW	55220	1	100		

Zinc plated / Verzinkt / Verzinkt / Zingué / Elförzinkad					
Type	Art. Nr.				
BRADF16-19MM-EL	62200	4000+4	32000+32	19	1,6
BRADF16-25MM-EL	62220	4000+4	32000+32	25	1,6
BRADF16-29MM-EL	62240	4000+4	32000+32	29	1,6
BRADF16-32MM-EL	62250	4000+4	32000+32	32	1,6
BRADF16-35MM-EL	62260	4000+4	16000+16	35	1,6
BRADF16-38MM-EL	62270	4000+4	16000+16	38	1,6
BRADF16-45MM-EL	62290	4000+4	16000+16	45	1,6
BRADF16-50MM-EL	62300	4000+4	16000+16	50	1,6
BRADF16-64MM-EL	62320	4000+4	16000+16	64	1,6

A2 steel / A2 staal / A2 Edeldstahl / acier A2 / A2 stål					
Type	Art. Nr.				
BRADF16-25MM-SS	62230	4000+4	32000+32	25	1,6
BRADF16-32MM-SS	62235	4000+4	32000+32	32	1,6
BRADF16-38MM-SS	62280	4000+4	16000+16	38	1,6
BRADF16-45MM-SS	62285	4000+4	16000+16	45	1,6
BRADF16-50MM-SS	62310	4000+4	16000+16	50	1,6
BRADF16-64MM-SS	62330	4000+4	16000+16	64	1,6

FORCED ENTRY





Nails Pneumatic

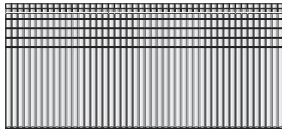

Straight brads for Powers F16, pneumatic tackers and DeWalt® DC616KB

Rechte brads voor Powers F16, pneumatische afwerktrackers en DeWalt® DC616KB

Stauchkopfnägels für Powers F16, Druckluft-Streifennagler und DeWalt® DC616KB

Clous de finition pour Powers F16, cloueurs pneumatiques et DeWalt® DC616KB

Dyckert rak för Powers F16, pneumatiska häftpistoler och DeWalt® DC616KB

Zinc plated / Verzinkt / Verzinkt / Zingué / Elförzinkad

Type	Art. Nr.				
BRADF16-19-EL NO GAS	62770	4000	32000	19	1,6
BRADF16-25-EL NO GAS	62772	4000	32000	25	1,6
BRADF16-32-EL NO GAS	62776	4000	32000	32	1,6
BRADF16-35-EL NO GAS	62778	4000	16000	35	1,6
BRADF16-38-EL NO GAS	62780	4000	16000	38	1,6
BRADF16-45-EL NO GAS	62782	4000	16000	45	1,6
BRADF16-50-EL NO GAS	62784	4000	16000	50	1,6
BRADF16-64-EL NO GAS	62786	4000	16000	64	1,6

A2 steel / A2 staal / A2 Edelstahl / acier A2 / A2 stål

Type	Art. Nr.				
BRADF16-32-SS NO GAS	62789	4000	32000	32	1,6
BRADF16-38-SS NO GAS	62790	4000	16000	38	1,6
BRADF16-45-SS NO GAS	62791	4000	16000	45	1,6
BRADF16-50-SS NO GAS	62792	4000	16000	50	1,6
BRADF16-64-SS NO GAS	62794	4000	16000	64	1,6

FORCED ENTRY

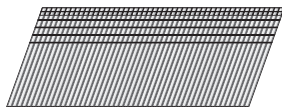
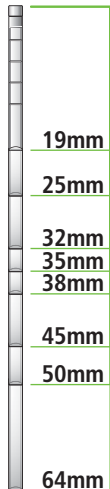

20° Angle brads fitting pneumatic tackers and DeWalt® DC618KB

20° Schuine brads passend voor pneumatische afwerktrackers en DeWalt® DC618KB

20° Schräge Stauchkopfnägels für Druckluft-Streifennagler und DeWalt® DC618KB

Pointes angle 20° pour cloueurs pneumatiques et DeWalt® DC618KB

Dyckert snellställd 20° för pneumatiska häftpistoler DeWalt® DC618KB

Zinc plated / Verzinkt / Verzinkt / Zingué / Elförzinkad

Type	Art. Nr.				
ANGLEBRAD-32EL NO GAS	62750	2000	12000	32	1,6
ANGLEBRAD-38EL NO GAS	62752	2000	12000	38	1,6
ANGLEBRAD-45EL NO GAS	62754	2000	12000	45	1,6
ANGLEBRAD-50EL NO GAS	62756	2000	12000	50	1,6
ANGLEBRAD-64EL NO GAS	62758	2000	12000	64	1,6

A2 steel / A2 staal / A2 Edelstahl / acier A2 / A2 stål

Type	Art. Nr.				
ANGLEBRAD-32SS NO GAS	62760	2000	12000	32	1,6
ANGLEBRAD-38SS NO GAS	62762	2000	12000	38	1,6
ANGLEBRAD-45SS-NO GAS	62763	2000	12000	45	1,6
ANGLEBRAD-50SS NO GAS	62764	2000	12000	50	1,6
ANGLEBRAD-64SS NO GAS	62766	2000	12000	64	1,6

