



PNEUMATIC TABLE FOR NAILING PALLETS

pneumatico PT-1900

adjustable for various sizes



PNEUMATIC TABLE FOR NAILING PALLETS **pneumatico** PT-1900

(possible viability of PT-2300, PT-2800, PT-3300)

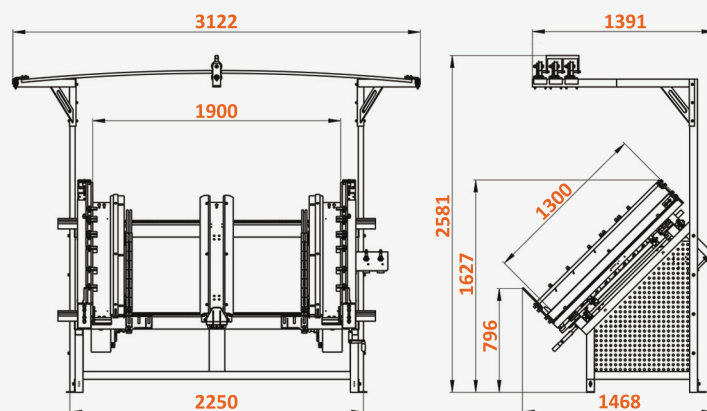

Table Pneumatico **PT-1900** is a universal machine for hand nailing of various wood pallets. Its top part contains a frame equipped with mobile carts for balancers, where the nailers are hung. Pneumatico **PT-1900** assures easiness and work study. It guarantees the increase of effectiveness and saves the space (it takes up 4 m²). What is more, it saves the costs of pattern preparation for various pallets.

During traditional nailing two workers produce about 250 pallets on one shift. During the same time 210-230 pallets can be produced by one individual worker when Pneumatico PT-1900 table is used.

Pneumatico PT-1900 table:

- assures work efficiency;
- plays the role of an adjustable pattern for EUR pallets on 2,3 or 4 bearers;
- designed for worker's individual use;
- gives the possibility of easy readjustment from one size to another;
- holds the pneumatic function of clamping the bearers and lifting the ready-made pallet;
- assures the work study by the system of hanging nailers on balancers.



The size of Pneumatico PT-1900 table in mm

ASSEMBLAGE OF EUR - TYPE PALLETS

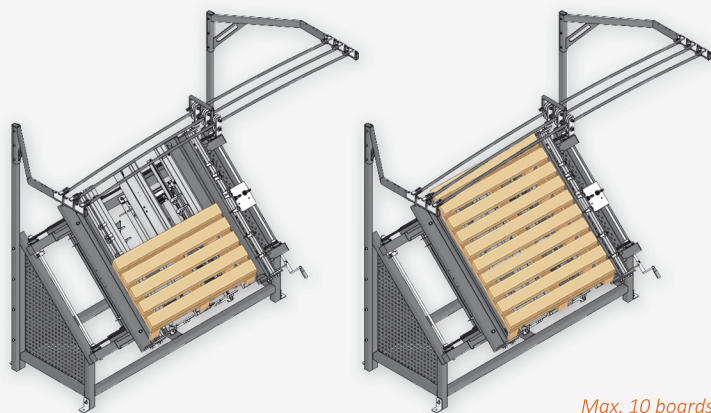

Four-way entry EUR pallets

The stages of nailing:

- laying the blocks
- pneumatic clamping of the blocks
- nailing of the top boards to the blocks
- pneumatic lifting to turn the pallet
- nailing the bottom boards to the blocks
- lifting the ready-made pallet

Dimensions of particular elements:

- 65 - 140 mm
- 70 - 110 mm
- max. 1300 mm
- 65 - 140 mm
- 15 - 27 mm
- 900 - 1900 mm

Two-way entry EUR pallets

(on 2, 3 or 4 stringers)

Dimensions of particular elements:

- 40 - 125 mm
- 600 - 1300 mm
- 75 - 140 mm
- 800 - 1900 mm
- min. 16 mm

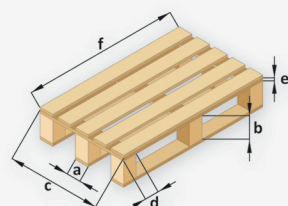
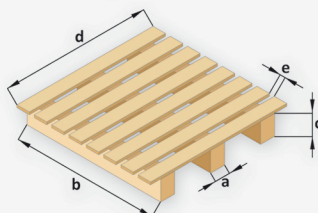
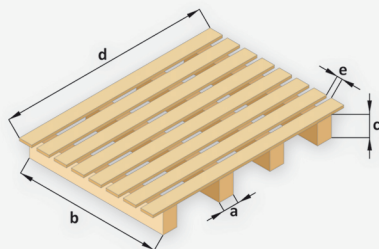

ASSEMBLAGE OF SEMI - FINISHED PRODUCTS

(bottom boards with 2 or 3 bearers)

The standard accessories of Pneumatico **PT-1900** table comprises of 3 elements of additional equipment for laying 9 sets of bottom part elements to nail the boards.

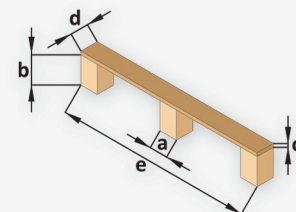
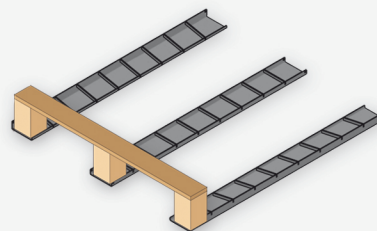

Dimensions of particular elements:

- 70 - 135 mm
- 70 - 120 mm
- 12 - 27 mm
- 10 - 125 mm
- 800 - 1900 mm

